

SITE KEYNOTES

- SAWCUT 2' MIN TO PROVIDE NEAT EDGE. TACK, TRIM, AND JOIN TO MATCH EXISTING PAVEMENT.
- INSTALL ASPHALT CONCRETE PAVEMENT SECTION PER DETAIL B THIS SHEET.
- INSTALL CONCRETE HEADER PER PAG STD DTL 213.
- EXISTING LIGHT POLE TO REMAIN IN PLACE.
- EXISTING ELECTRIC PULL BOX TO BE ADJUSTED TO GRADE.
- EXISTING CONCRETE VERTICAL CURB TO REMAIN.
- EXISTING CONCRETE PAD, MATCH PAVEMENT GRADE TO EXISTING.
- EXISTING CONCRETE SIDEWALK TO REMAIN.
- EXISTING BROKEN GATE TO BE REMOVED AND DISPOSED BY OWNER

20 10 0 20 40
SCALE: 1" = 20'
C.I. = 1'

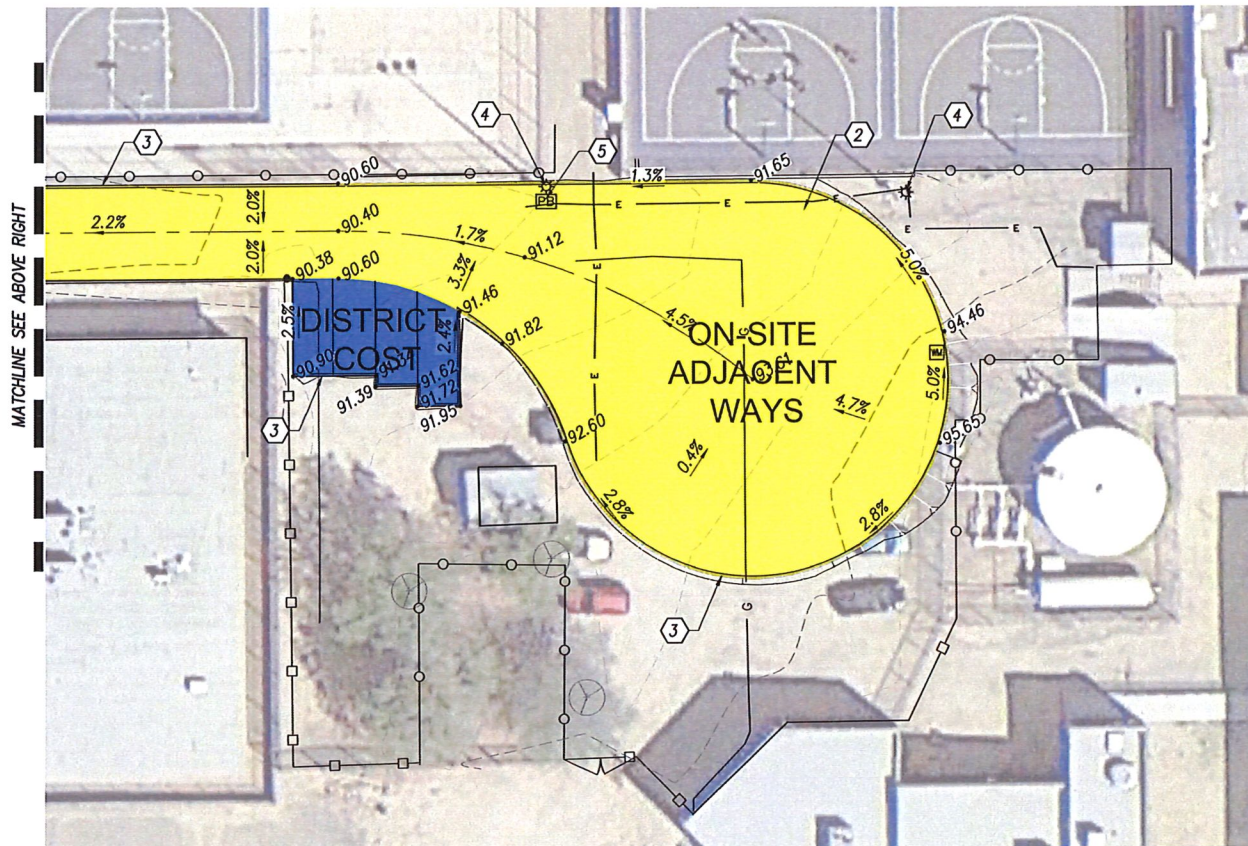

No Off-Site Adjacent Ways

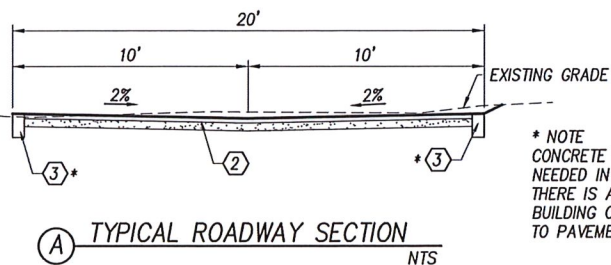
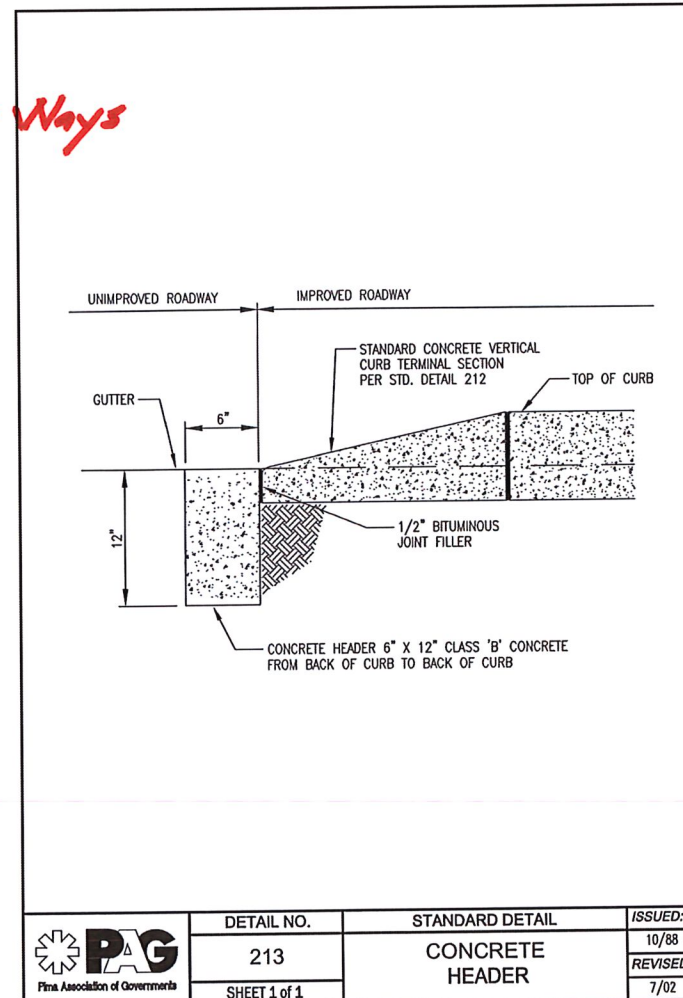

* NOTE
CONCRETE HEADER IS NOT
NEEDED IN AREAS WHERE
THERE IS AN EXISTING
BUILDING OR WALL ADJACENT
TO PAVEMENT EDGE.

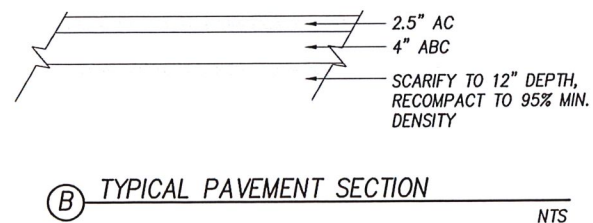

DETAIL NO.	STANDARD DETAIL	ISSUED:
213	CONCRETE HEADER	10/88
SHEET 1 of 1		REVISED: 7/02



Engineering and Environmental Consultants, Inc.
555 E. River Road, Suite 301 | Tucson, Arizona 85704
Tel 520.321.4625 | Fax 520.321.0333

civil engineering • land development
surveying • environmental services
staging • flood control and drainage
transportation

ECC JOB No. 19028

Amphitheater Public Schools
Canyon del Oro High School
Fire Lane



PROJECT NO:
17.14.43

DATE:
NOVEMBER 2019

REVISION	DATE	DESCRIPTION	ISSUED TO

DRAWN BY: JBY
CHECKED BY: RRS

THIS DRAWING IS NOT TO BE USED FOR
CONSTRUCTION PURPOSES UNLESS IT IS SIGNED AND SEALED BY AN ARCHITECT
OR ENGINEER OF RECORD AND THE SEAL OF THE ARCHITECT OR ENGINEER IS
PLACED ON THE DRAWING.

Civil
Grading Plan

C2.0